

DRUID 4/13

Druid Mk. IV/13 is an upgrade for previous Druid 4 and Druid 4/08 owners. There were two stages. Stage One was for those that did not want to perform surgery on their cabinet as the Stage Two kit required routing or precise jig-saw work.

Stage One replaced the full-range driver with the new 103 driver, the same featured in the Druid 5, and a new tweeter which fit the cabinet without modification and its high-pass network and lens.

Stage Two was for the ambitious, those that had the tools and skills to fit the big Radian 850 based tweeter assembly in the Druid 4 and 4/08 cabinets. High-pass network for the Radian 850 based tweeter was also part of the tweeter assembly package. Stage Two also included a new nameplate and Event based cable harness assembly, the same use in Druid 5 but marked Druid Mk. IV/13

Identification on what work was done is through viable physical parts. The full-range driver was engraved with the 103 mark on the center cone. The Radian based tweeter was not marked but is much larger than the original four inch [10.2 cm] outside diameter lens. If the tweeter was also replaced the outside diameter of the lens would be 5.44 inches [13.8 cm] and would have a small scallop cut from it where the full-range driver frame protrudes into the lens a bit. If the internal cable harness was changed the nameplate was also changed and would have the ZuB3 connection and the mark of Druid Mk. IV/13

Druid 4/13 Upgrade kit was offered from 2013 through 2020.

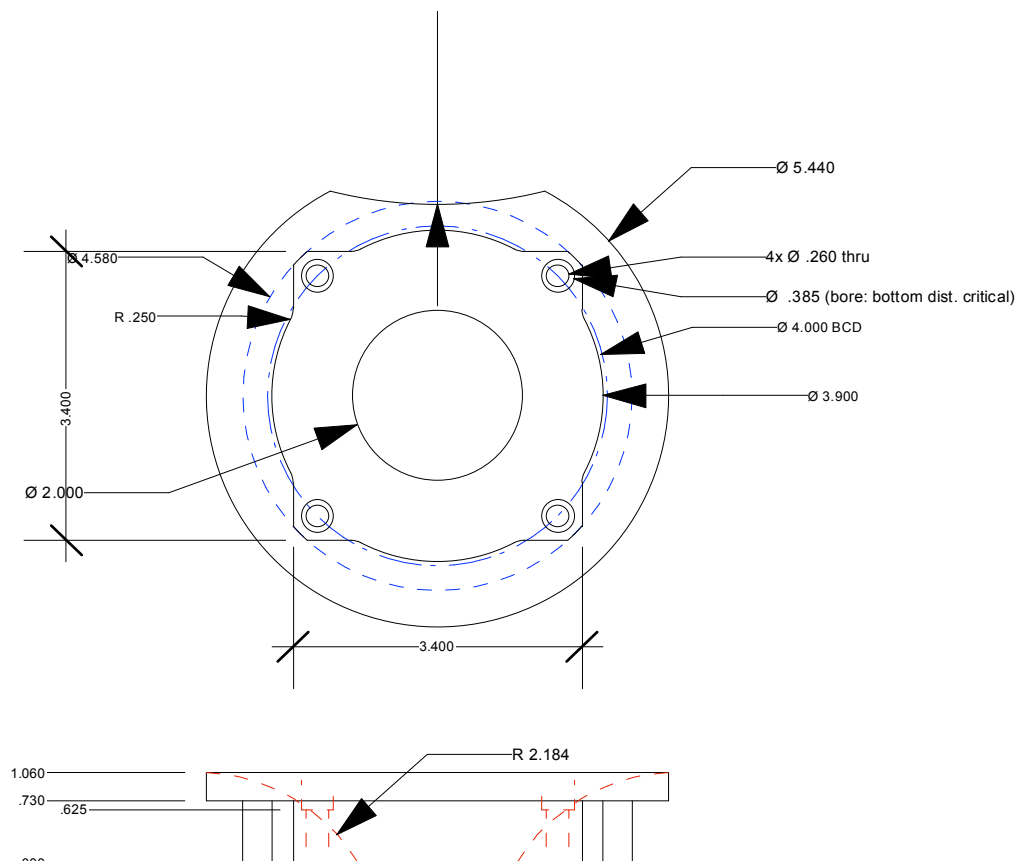

SUMMARY [v1]



Brief Overview of Druid Versions

2001 - Original Druid launched. Featured machined from billet aluminum everything including base. Zu260FR driver with accordion surround and max shove motor, complimented by a 3/4" French made Audax high output dome tweeter. Speakon 8-pole connector facilitating B3 interface for loudspeaker cable input along with Cardas Patented Binding Post for traditional spade inputs.

2002 - Druid 2 [Mark II] introduced with revised super-tweeter filter and improved cabinet construction.

2003 - Druid 3 [Mark III] Audax informs Zu that they can no longer produce the tweeter we are using as they are closing their French production of hi-fi drivers. Zu scrambles to finish the driver lens and network. Druid-3 features this new machined from billet lens, driven by the composite dome Eminence super tweeter. Zu260FR/G2 was also introduced and featured a double-roll surround and revised motor for improved bass response. B3 interface is dropped as a feature to help keep price down. Billet aluminum base was replaced by a silver painted wood core plinth also to keep costs down.

2004 - Druid 4 [Mark IV] is launched with slightly improved cabinet due to adhesive changes, improved fabrication technique and precision. Improved harness assembly with the reduction of joints and solder. Revised super-tweeter network. Addition of iridescent and matte finishes. Matte finish is a true matte, but is rough like sandstone.

2008 - Druid 4/08 [Mark IV/08] is launched. Changes are plentiful, with the focus being on a much improved super tweeter. Market and reviewers find Druid and gush.

2012 - Druid 5 launches. See its summary for details.

2013 - Druid 4/13 Upgrade kit for Druid 4 owners to upgrade their older Druid to come close to Druid 5.
2017, Druid 6 launches. Everything changes.

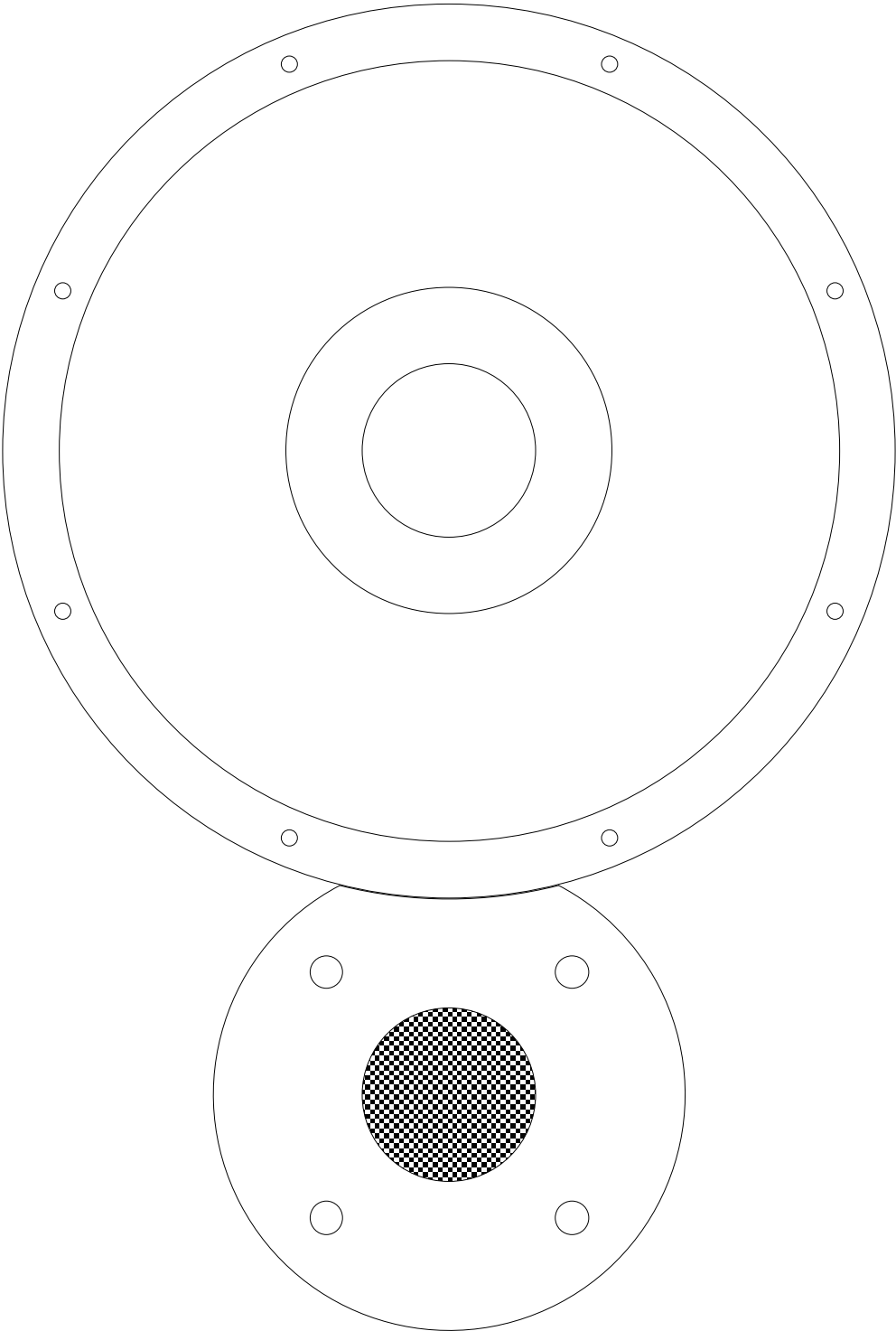

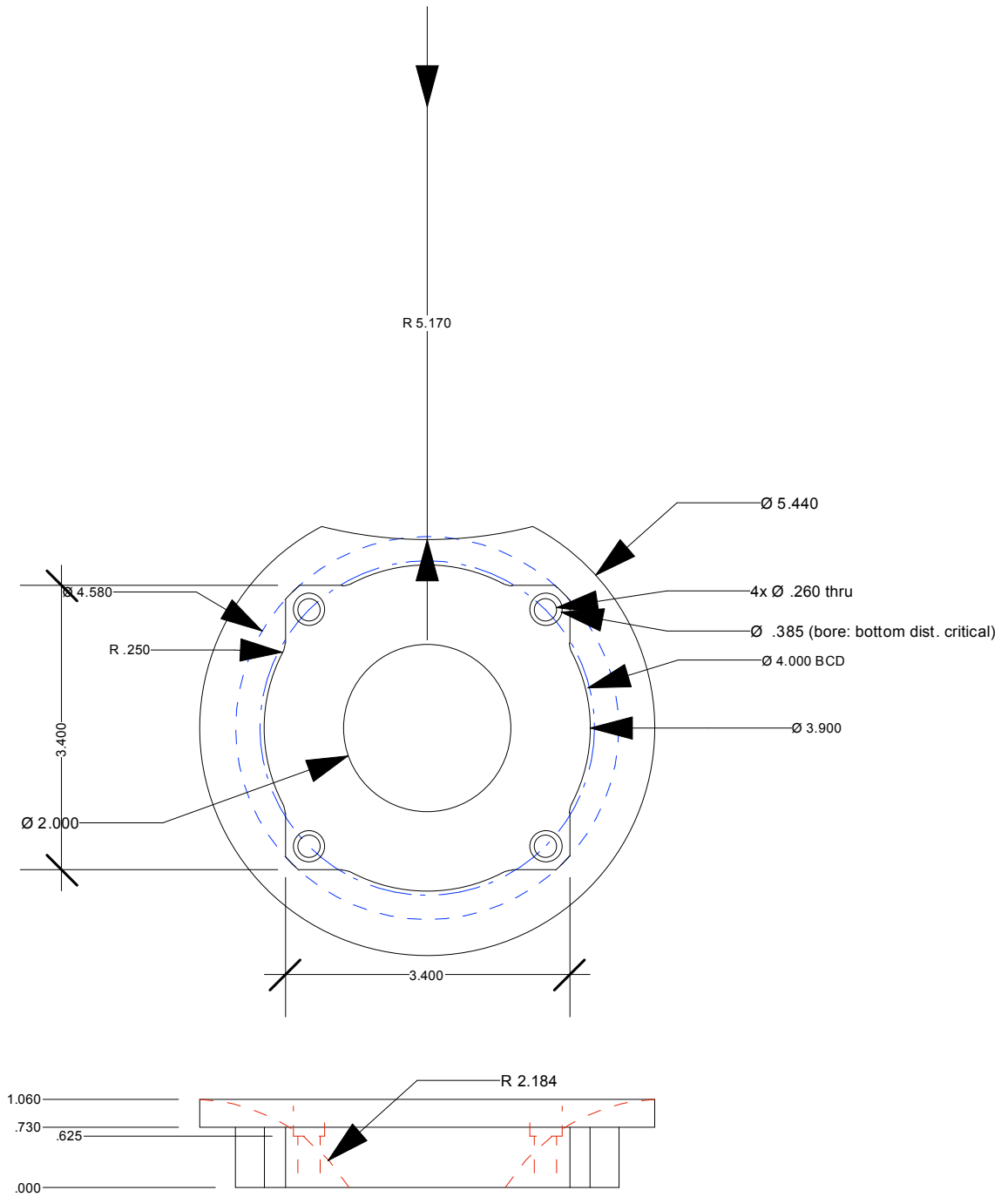



7.440

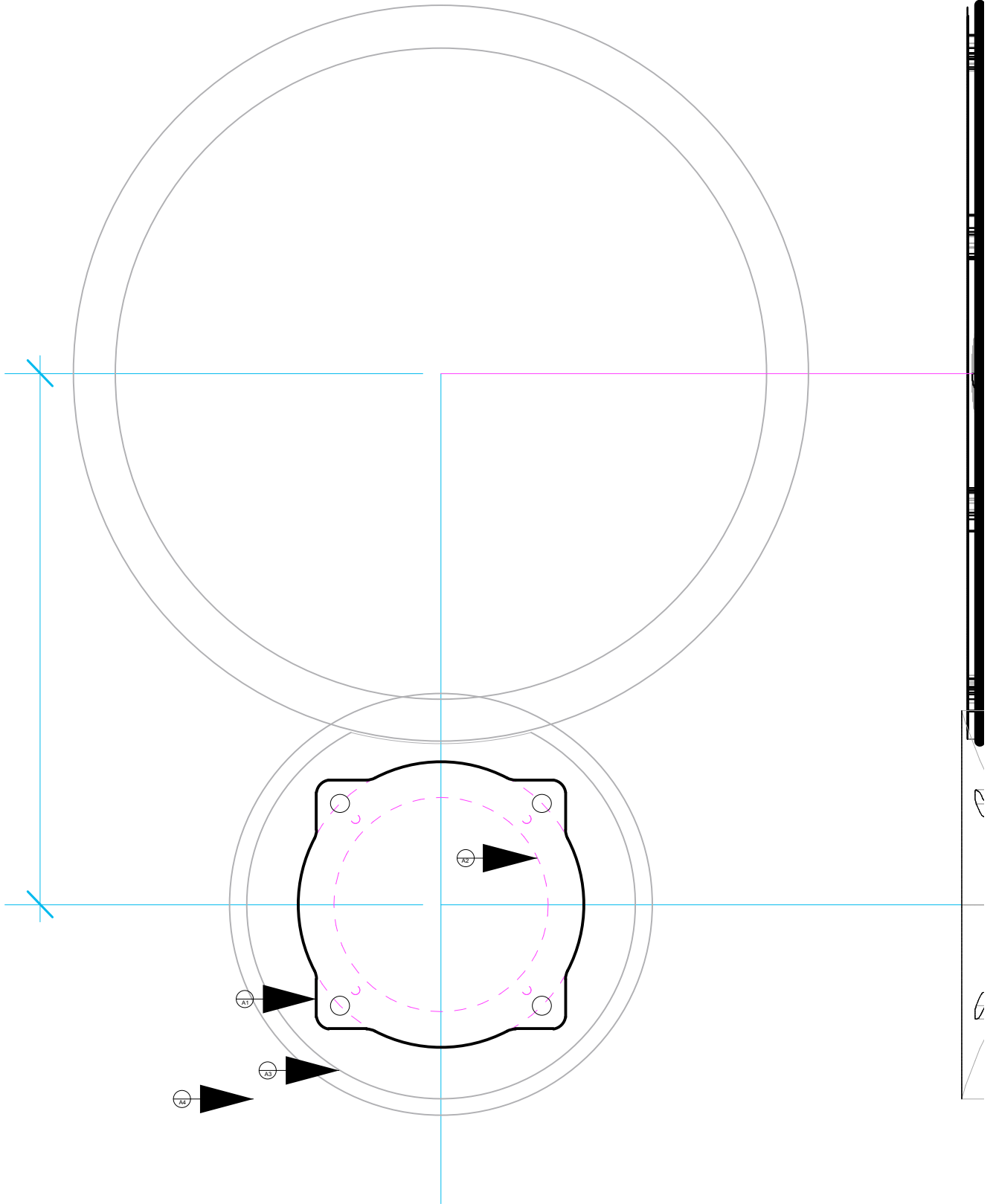

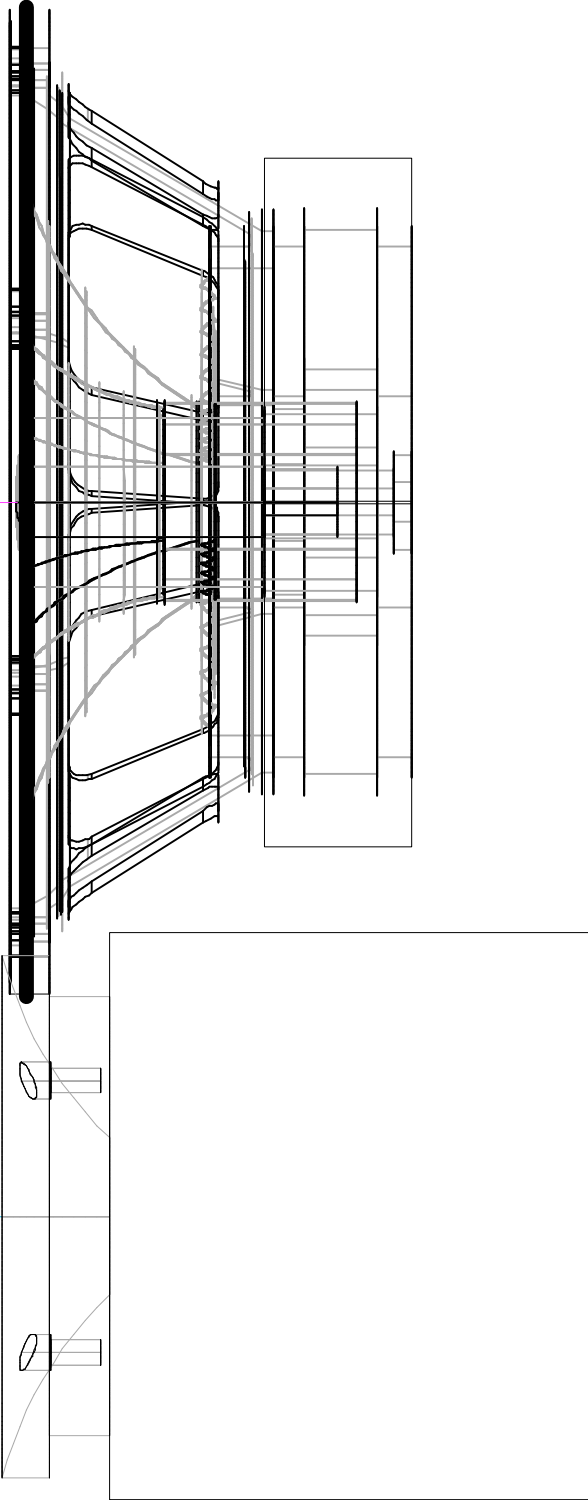
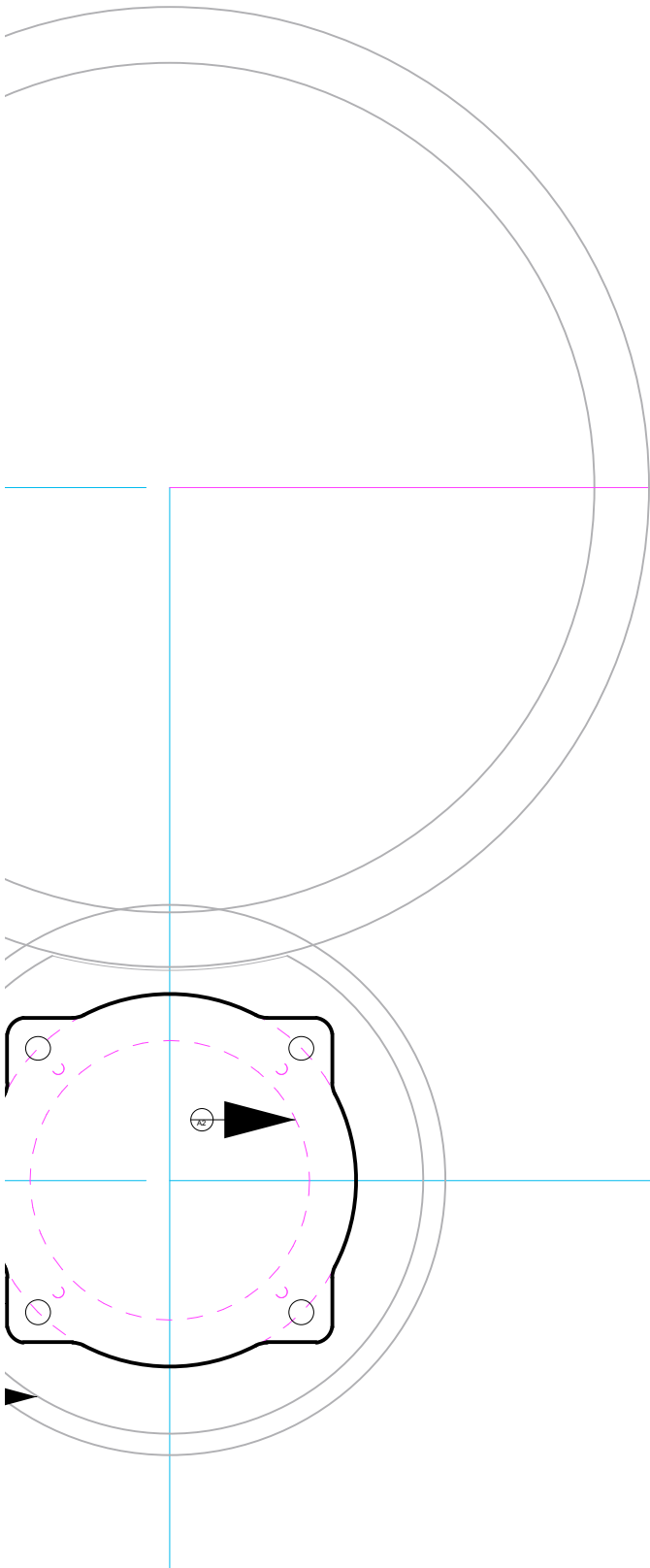

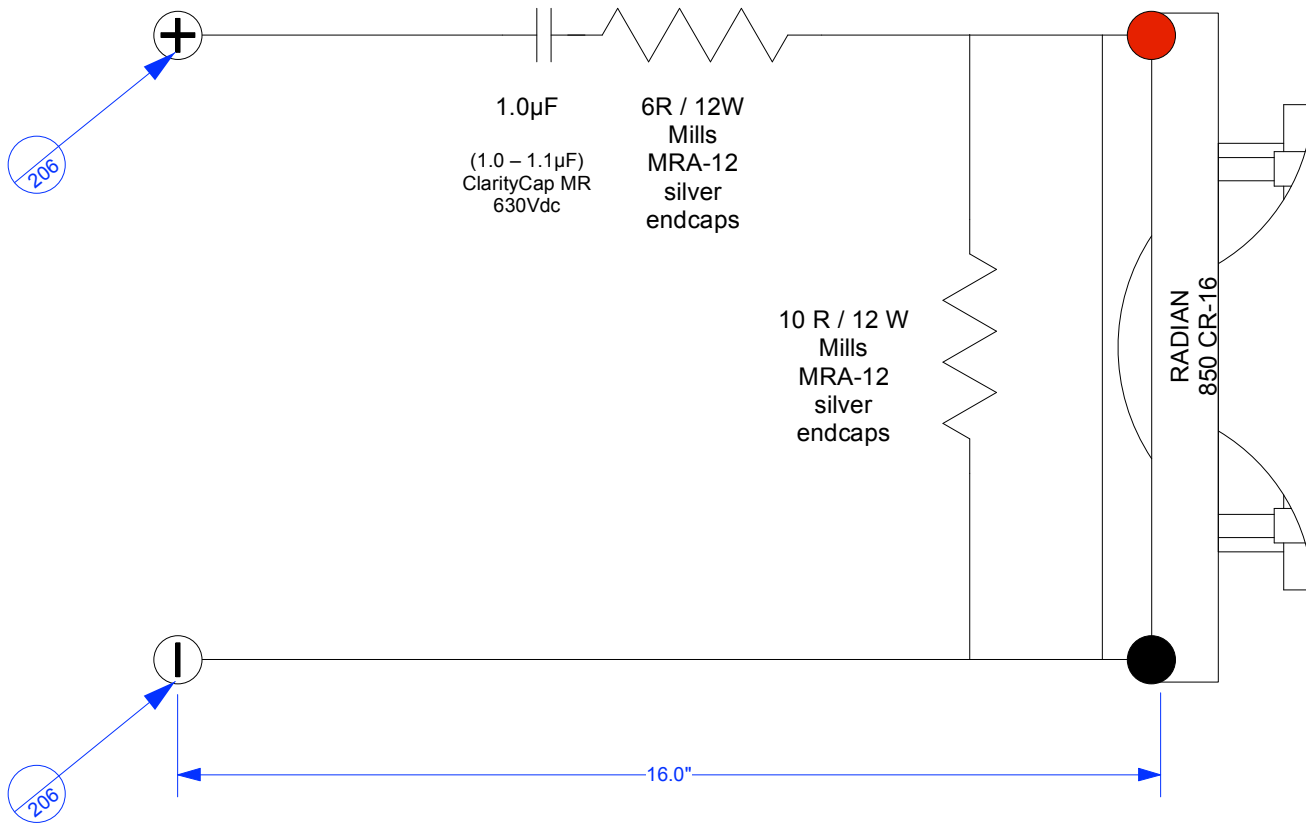

	NOTES LEAD WIRE = Zu EVENT #20	PROPRIETARY AND CONFIDENTIAL PROPERTY OF ZU CABLE INC. THE INFORMATION CONTAINED IN THIS DRAWING IS THE SOLE PROPERTY OF ZU AUDIO. ANY REPRODUCTION IN PART OR AS A WHOLE WITHOUT THE WRITTEN PERMISSION OF ZU AUDIO IS PROHIBITED.	TITLE DRUID-Mk.IV/13_HIGH-PASS		
	MATERIAL		SHEET 1/1	DRAWING SMC	REVISION A

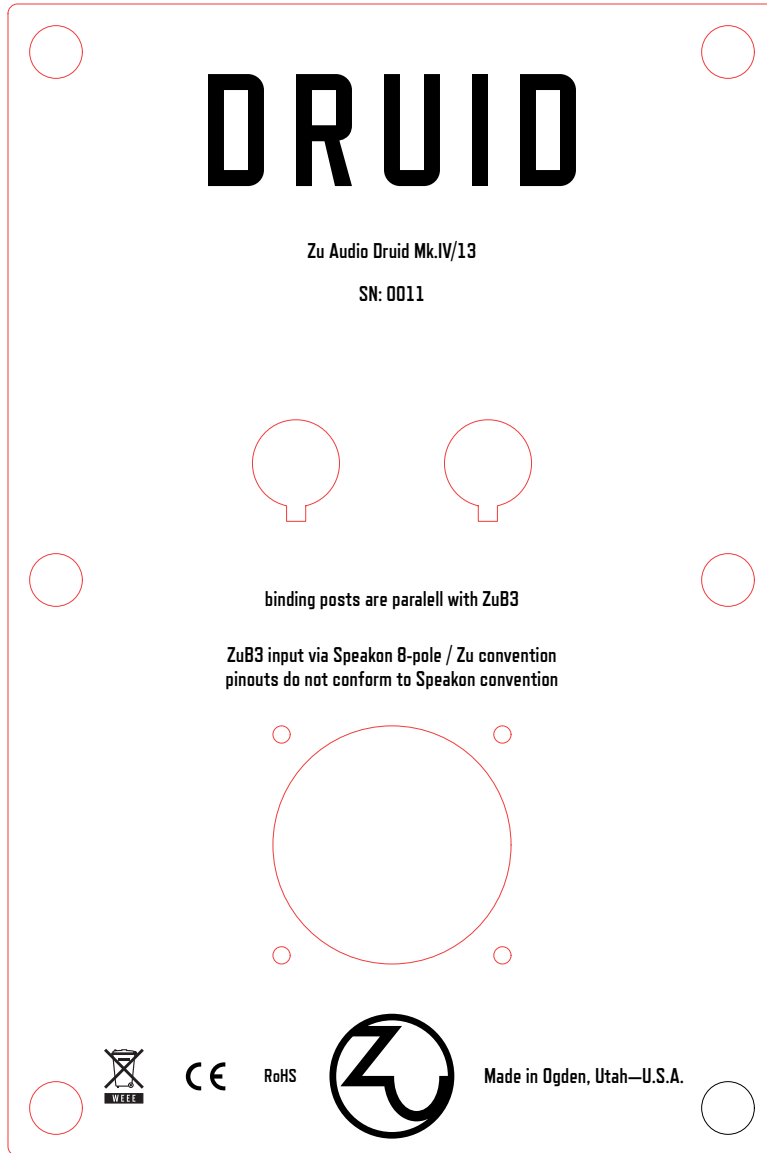



ZU AUDIO
Ogden, Utah, USA

DESIGNED AND MADE BY US